

## Edge welded bellow data sheet

**Part name: KF40EWB-20**

**Part number: 303451**

**date: 01.11.2016**

Geometric dimensions			Technical specifications		
Inner diameter	[mm]	39	Vacuum side	Inside	
Outer diameter	[mm]	59	Helium leak rate	[mbar·l/s]	$1 \cdot 10^{-9}$
Assembly length L min	[mm]	35	Operating temperature	[°C]	20
Assembly length L max	[mm]	55	Bakeout temperature	[°C]	80
Axial stroke	[mm]	20	Total weight	[g]	32
Number of convolutions		10	Spring constant axial	[N/mm]	6.5
End piece length L1	[mm]	15	Tensile force axial*	[N]	33
End piece length L2	[mm]	15	Resulting force axial**	[N]	229
<b>Materials</b>			* required force to pull to maximum assembly length		
			** required force to hold on maximum assembly length during evacuation of the inner volume		
bellow	316L				
End pieces/ Flanges	316L		Number of cycles	10'000	

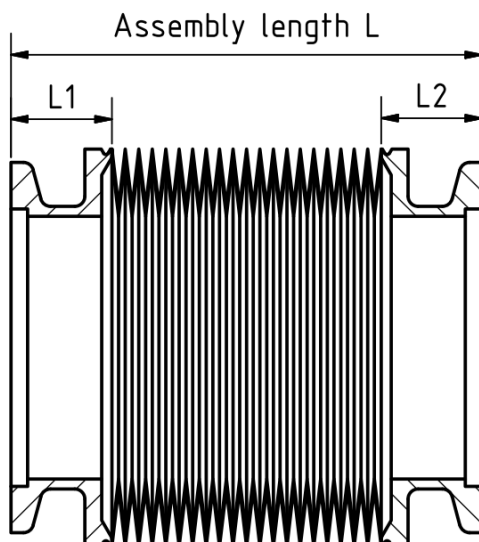

### Important note:

Number of cycles is describing the maximum number of strokes during the life time. Improper installation or use of the bellows out of specifications result in a reduction of life time. Please avoid especially any torsional load and pollution with particles